

Owner's Manual

These instructions **MUST** be read before operating this machine.

Congratulations on your purchase of the

V-TUF MAMMOTH 110



Technical Information

Model	MAMMOTH110
Capacity	90 Litres
Working Voltage	110 Volts
Power	2000 Watts
Function	Wet/Dry Vacuuming
Air Flow Rate	120 L/sec
Vacuum Suction	250 M/Bar
Cooling Mode	Circulating
Tank Diameter	Ø440mm
Height	1050mm
Accessories	Ø40mm
Power Cable	8 Meters

Safety Instructions

These instructions are for the user's safety, and all users of the V-TÜF cleaning equipment should ensure to have read this literature before using the machine.

- Do not use with a damaged cable.
- Do not run over the cable.
- Do not expose to liquid or moisture.
- Should be inaccessible for children and pets.
- Do not use outdoors.
- Do not use in the presence of flammable gasses.
- Do not clean up any hot material, e.g. ash.
- Always turn off the machine, and then unplug it, before you service the machine.
- **Do NOT use this machine without the filter INCLUDED**

All repairs on V-TÜF products should be done by a V-TÜF service representative.

- If the machine shuts down, be sure to turn off the machine and unplug it before troubleshooting.
- For safety, the machine contains an electronic overload protection.
- Always turn off and unplug the machine when it is not in use.
- If any part of the appliance becomes damaged or fractured, it must be replaced by a V-TÜF engineer.

Operating Instructions

All V-TÜF Products should arrive to the consumer as ready to use immediately. Simply, plug in to the mains outlet, then start the machine by moving the on/off switch to the 'on' position.

Motor Protection Filter & Exhaust Filter

The motor protection filter is only accessible by removing the filter. Lift the motor protection filter up by the bracket. When replacing the motor protection filter make sure that it is pressed in position tightly. The motor protection filter should be changed when it is dirty.

Change the exhaust filter at the same time as the motor protection filter. To do this, carefully remove the filter retaining rings and put them to the side. Next pull the enforcement strips of the exhaust filter out of the housing slot and remove the exhaust filter from the housing.

When reassembling, please ensure the exhaust filter is fitted correctly in the housing slots and the filter retaining rings are installed correctly.

Only use genuine V-TÜF replacements on the appliance.

Accessories

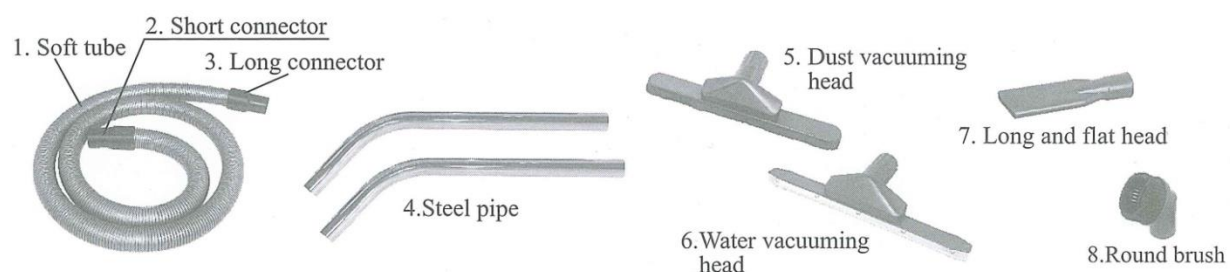

Machine Components

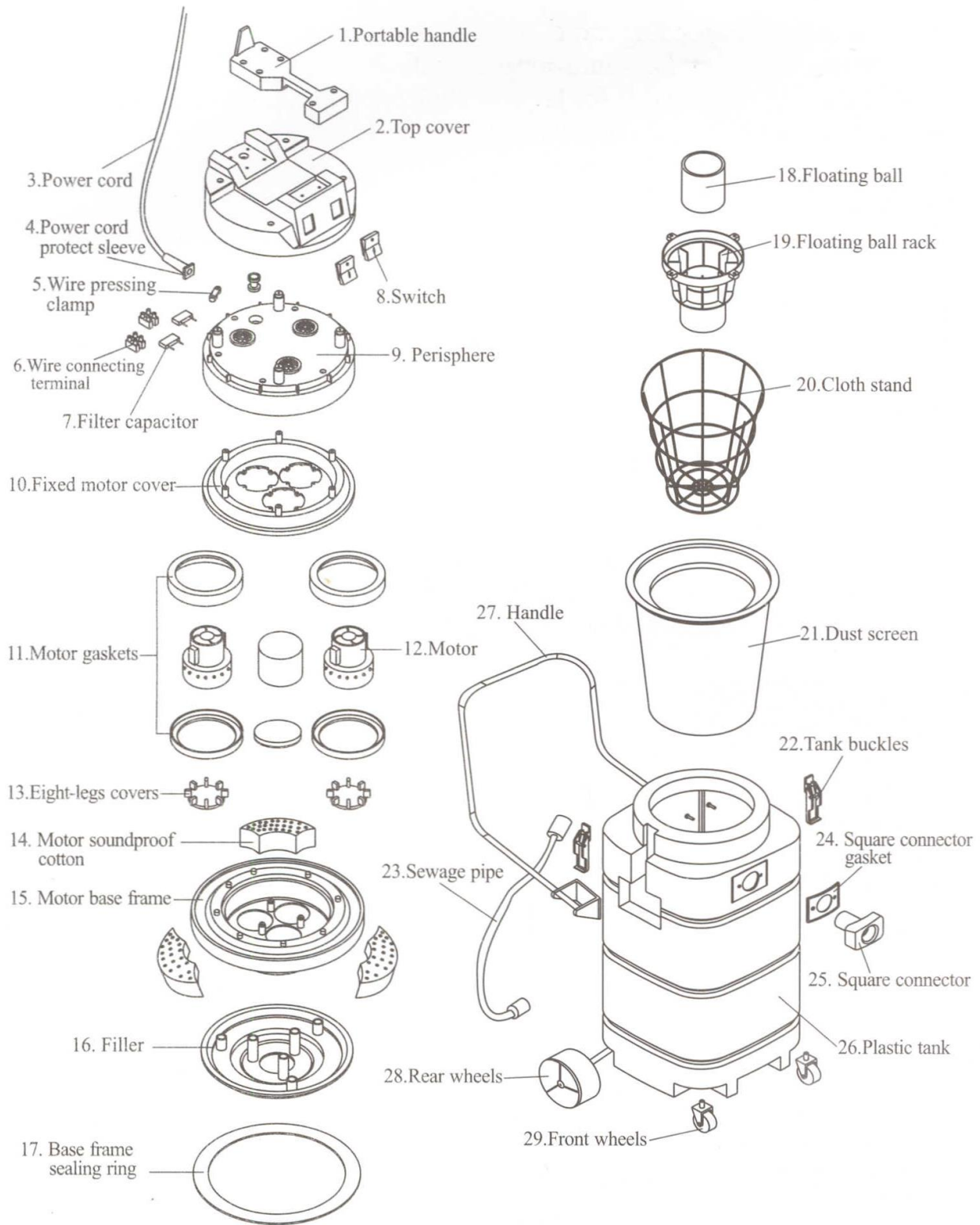

Never allow children to meddle with this appliance.